

# A1009 501330 CONNECTOR

1.00mm Pitch/Disconnectable Crimp style connectors

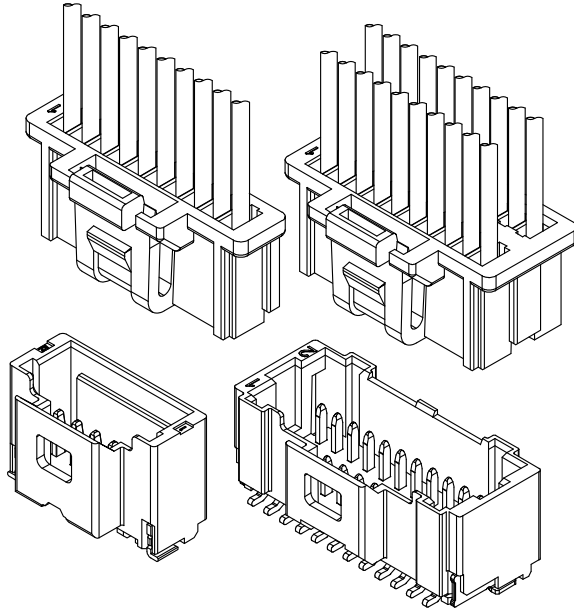

## Specifications:

- Current rating: 1,0 A AC,DC
  - Voltage rating: 100 V AC/DC
  - Temperature range: -25°C ~ +105°C  
(including temperature rise in applying electrical current)
  - Contact resistance: Initial value/ 30m Ω max  
After environmental testing/ 40m Ω max
  - Insulation resistance: 500 M.Ω min
  - Withstanding voltage: 500 VAC/minute
  - Applicable wire: Conductor size/ AWG#32 to #28
- \* Compliant with RoHS2/ REACH/ HF  
 \* In using the products, refer to "Handling Precautions for Terminals and Connectors "described on our website (Technical documents of Product information page).  
 \* Contact CSG for details

## Material:

Housing: PA66,UL94-V0;Color:White  
 Terminal: Phosphor/ Tin-plated, Gold-Plated  
 Wafer Housing: LCP/ 4T/ 9T,UL94-V0;Color:Natural/ Black  
 Wafer Pin: Phosphor/ Tin-plated  
 Wafer Fixed Foot: Brass/ Tin-plated

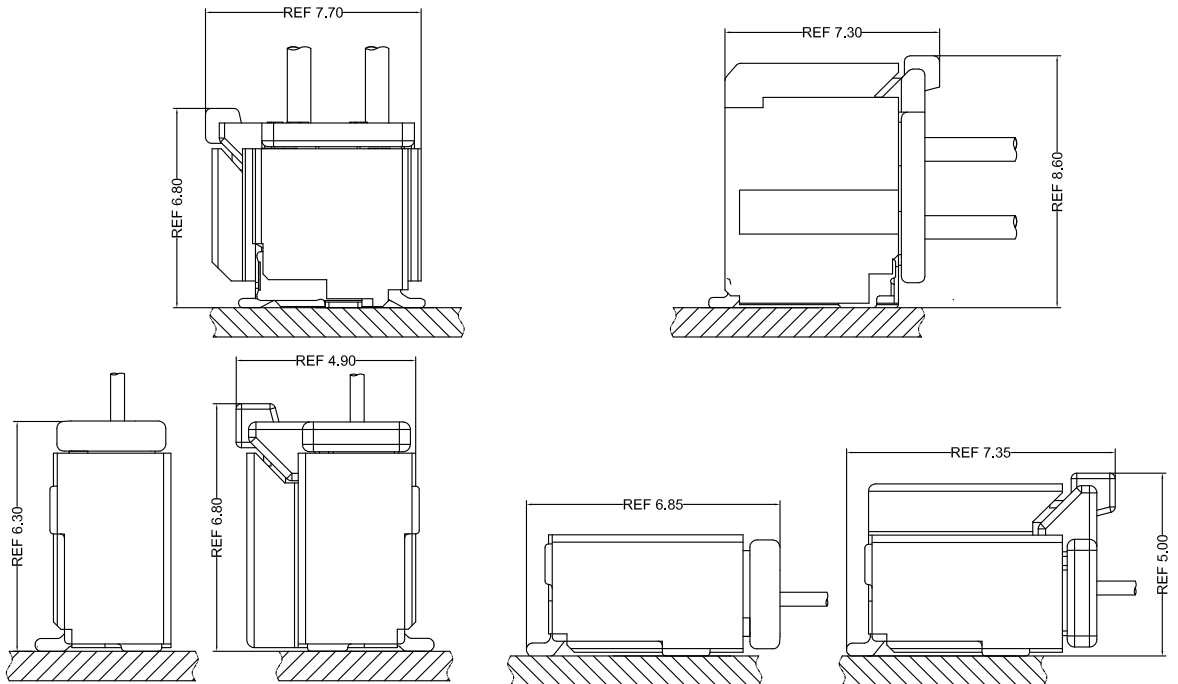

- Note: 1. The above figure is the figure viewed from the connector mounting side.  
 2. Tolerances are non-cumulative: ±0.08 mm for all centers.  
 3. The dimensions above should serve as a guideline. Contact CSG for details.



# A1009 501330

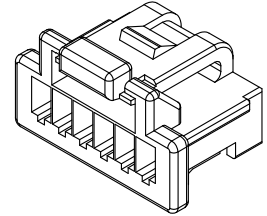
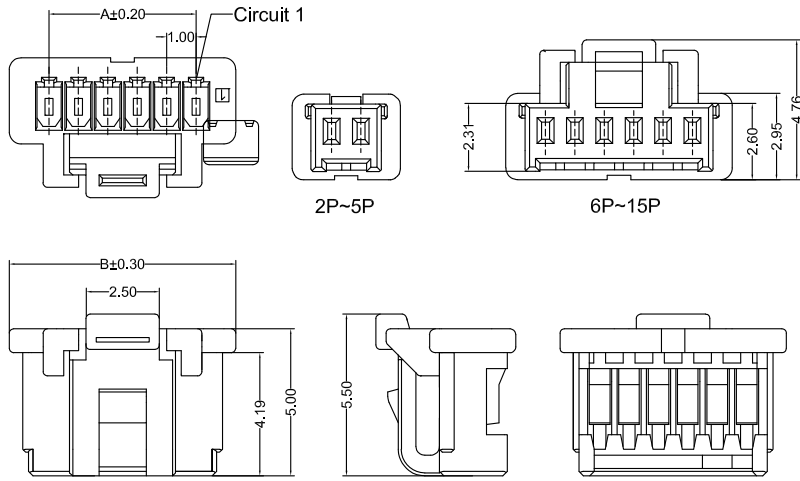

A1009HF 0XX AA P6 9 006

PIN  
002=2PINS

SPECIAL  
AA=NO Protrusions  
AK=BUCKLE

Material  
P6=PA66 94V-0

Code  
006

Color  
9=White

CSG PART NO.	Dimension mm		Q'ty/BAG
	A	B	
A1009HF002AAP69006	1.00	3.70	1000PCS
A1009HF003AAP69006	2.00	4.70	1000PCS
A1009HF004AAP69006	3.00	5.70	1000PCS
A1009HF005AAP69006	4.00	6.70	1000PCS
A1009HF006AKP69006	5.00	7.70	1000PCS
A1009HF007AKP69006	6.00	8.70	1000PCS
A1009HF008AKP69006	7.00	9.70	1000PCS
A1009HF009AKP69006	8.00	10.70	1000PCS
A1009HF010AKP69006	9.00	11.70	1000PCS
A1009HF011AKP69006	10.00	12.70	1000PCS
A1009HF012AKP69006	11.00	13.70	1000PCS
A1009HF013AKP69006	12.00	14.70	1000PCS
A1009HF014AKP69006	13.00	15.70	1000PCS
A1009HF015AKP69006	14.00	16.70	1000PCS

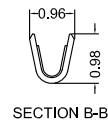
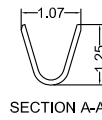
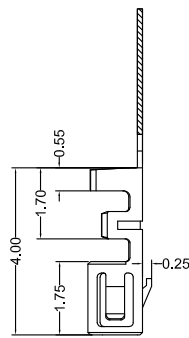
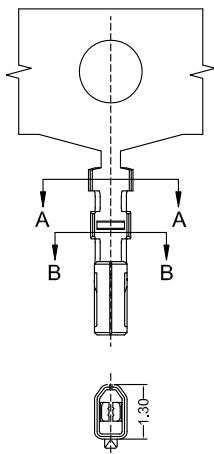

A1009 M 0 A XX 006

Type  
M=Female Terminal

Material  
A=Phosphor

Finish  
TP=TIn-Plated  
GF=Gold-Plated

Code  
006

CSG PART NO.	Wire Range	Insulation O.D.	Q'ty/Reel
A1009MOATP006	AWG#28-#32	0.75mm(max)	20000PCS
A1009MOAGF006	AWG#28-#32	0.75mm(max)	20000PCS



# A1009 501330

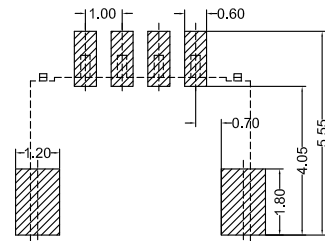
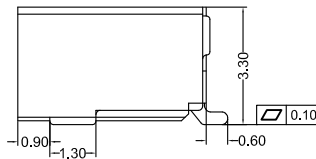
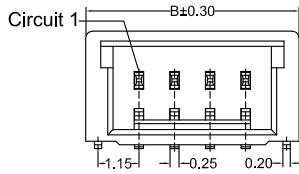
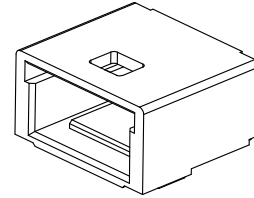
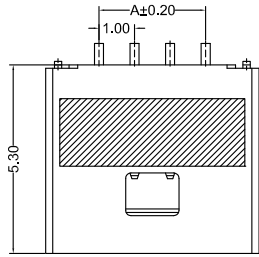

A1009RS.0XX AA LP TP B A 001  
 PIN  
 002=2PINS  
 SPECIAL  
 AA=NO Special  
 Material  
 LP=LCP 94V-0  
 Finish  
 TP=Terminal Tin-Plated

Code  
 001  
 Color  
 A=Natural  
 Packing  
 B=Tape & Reel

Recommended P.C.B Layout  
 General Tolerance±0.05

CSG PART NO.	Dimension mm		Qty/Reel
	A	B	
A1009RS002AALPTPBA001	1,00	4,00	1000PCS
A1009RS003AALPTPBA001	2,00	5,00	1000PCS
A1009RS004AALPTPBA001	3,00	6,00	1000PCS
A1009RS005AALPTPBA001	4,00	7,00	1000PCS

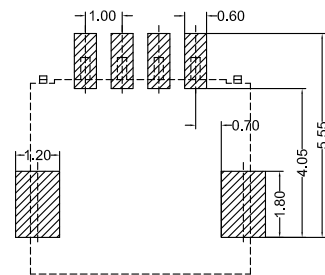
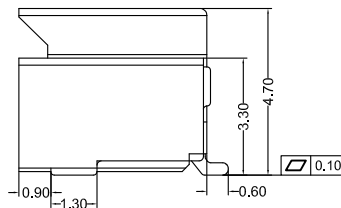
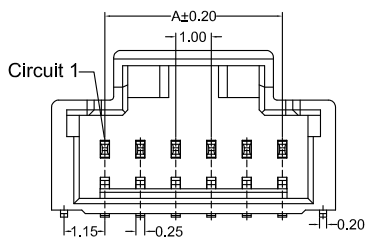
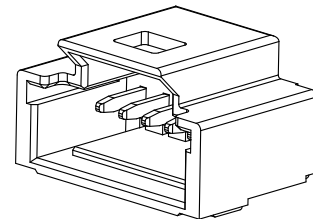
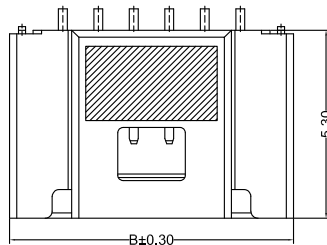

A1009RS.0XX AA 4T XX B A 001  
 PIN  
 002=2PINS  
 SPECIAL  
 AA=NO Special  
 Material  
 4T=PA4T 94V-0  
 Finish  
 TP=Terminal Tin-Plated  
 GF=Terminal Gold-Plated

Code  
 001  
 Color  
 A=Natural  
 Packing  
 B=Tape & Reel

Recommended P.C.B Layout  
 General Tolerance±0.05

CSG PART NO.	Dimension mm		Qty/Reel
	A	B	
A1009RS006AA4TXXBA001	5,00	8,00	1000PCS
A1009RS007AA4TXXBA001	6,00	9,00	1000PCS
A1009RS008AA4TXXBA001	7,00	10,00	1000PCS
A1009RS009AA4TXXBA001	8,00	11,00	1000PCS
A1009RS010AA4TXXBA001	9,00	12,00	1000PCS
A1009RS011AA4TXXBA001	10,00	13,00	1000PCS
A1009RS012AA4TXXBA001	11,00	14,00	1000PCS
A1009RS013AA4TXXBA001	12,00	15,00	1000PCS
A1009RS014AA4TXXBA001	13,00	16,00	1000PCS
A1009RS015AA4TXXBA001	14,00	17,00	1000PCS



# A1009 501330

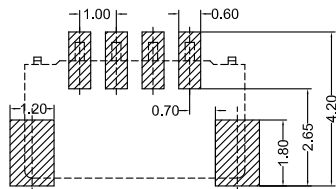
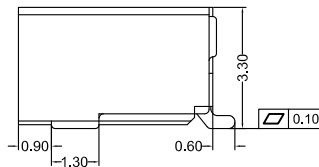
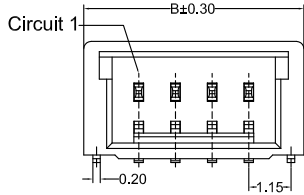
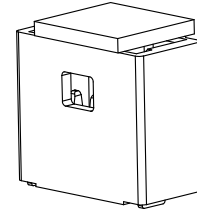
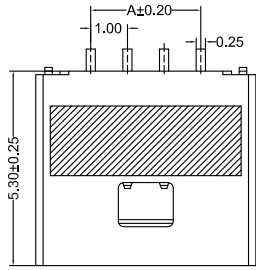

A1009RS.0XX AA LP TP BA 001

- PIN
- 002=2PINS
- SPECIAL
- AA=NO Special
- Material
- LP=LCP 94V-0
- Finish
- TP=Terminal Tin-Plated
- Code
- 001
- Color
- A=Natural
- Packing
- B=Tape & Reel

Recommended P.C.B Layout  
General Tolerance±0.05

CSG PART NO.	Dimension mm		Qty/Reel
	A	B	
A1009VS002AALPTPBA001	1.00	4.00	800PCS
A1009VS003AALPTPBA001	2.00	5.00	800PCS
A1009VS004AALPTPBA001	3.00	6.00	800PCS
A1009VS005AALPTPBA001	4.00	7.00	800PCS

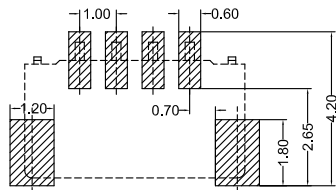
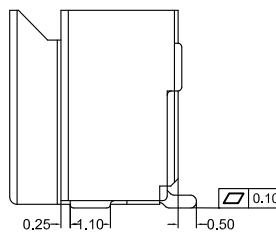
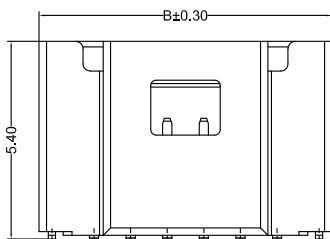
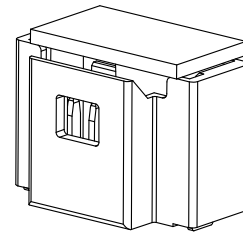
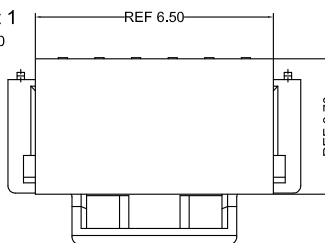
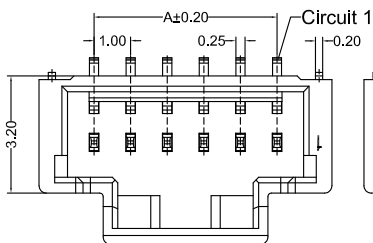

A1009VS.0XX AA 4T XX BA 001

- PIN
- 002=2PINS
- SPECIAL
- AA=NO Special
- Material
- 4T=PA4T 94V-0
- Finish
- TP=Terminal Tin-Plated
- GF=Terminal Gold-Plated
- Code
- 001
- Color
- A=Natural
- Packing
- B=Tape & Reel

Recommended P.C.B Layout  
General Tolerance±0.05

CSG PART NO.	Dimension mm		Qty/Reel
	A	B	
A1009VS006AA4TXXBA001	5.00	8.00	800PCS
A1009VS007AA4TXXBA001	6.00	9.00	800PCS
A1009VS008AA4TXXBA001	7.00	10.00	800PCS
A1009VS009AA4TXXBA001	8.00	11.00	800PCS
A1009VS010AA4TXXBA001	9.00	12.00	800PCS
A1009VS011AA4TXXBA001	10.00	13.00	800PCS
A1009VS012AALPTPBA001	11.00	14.00	800PCS
A1009VS013AA4TXXBA001	12.00	15.00	800PCS
A1009VS014AA4TXXBA001	13.00	16.00	800PCS
A1009VS015AA4TXXBA001	14.00	17.00	800PCS



# A1009 501330

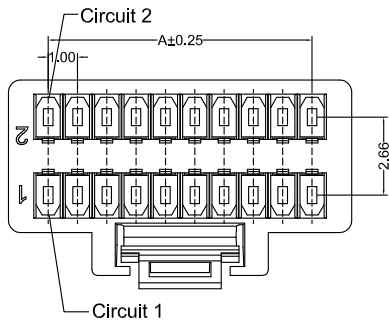

A1009HF 2XX AK P6 9 001  
 PIN 210=2X10PINS  
 SPECIAL AK=BUCKLE  
 Material P6=PA66 94V-0  
 Code 001  
 Color 9=White

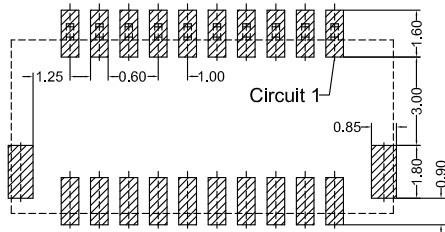
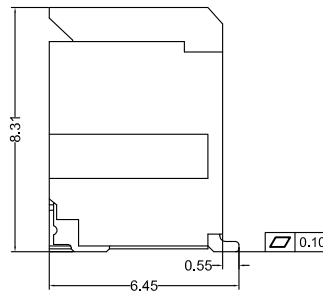
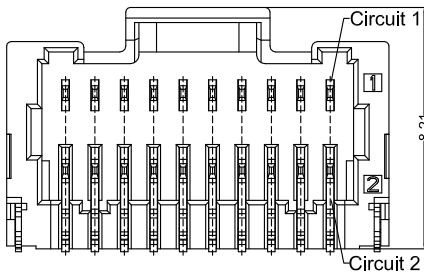
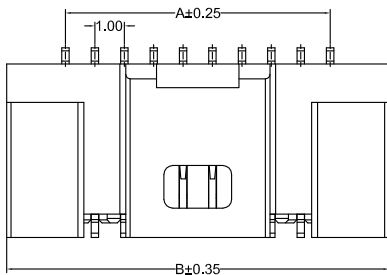
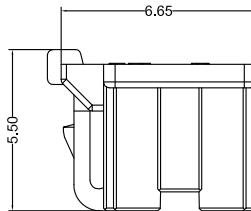
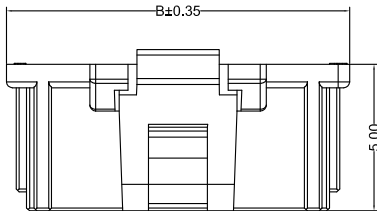
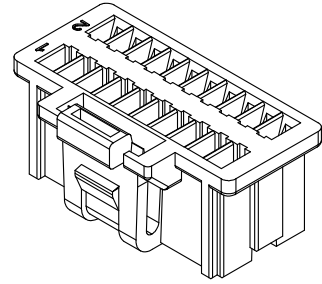

Recommended P.C.B Layout  
 General Tolerance±0.05

A1009RS 2XX AA 4T XX B X 001  
 PIN 210=2X10PINS  
 SPECIAL AA=NO Special  
 Material 4T=PA4T 94V-0  
 Finish GF=Terminal Gold-Plated  
 TP=Terminal Tin-Plated  
 Code 001  
 Color A=Natural  
 0=Black  
 Packing B=Tape & Reel

CSG PART NO.	Dimension mm		Q'ty/BAG
	A	B	
A1009HF210AKP69001	9.00	11.70	1000PCS
A1009HF215AKP69001	14.00	16.70	1000PCS
A1009HF220AKP69001	19.00	21.70	1000PCS
A1009HF225AKP69001	24.00	26.70	1000PCS

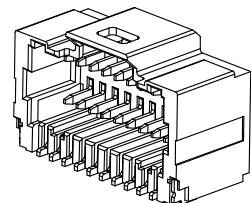

CSG PART NO.	Dimension mm		Q'ty/BAG
	A	B	
A1009RS210AA4TXXBX001	9.00	12.30	400PCS
A1009RS215AA4TXXBX001	14.00	17.30	400PCS
A1009RS220AA4TXXBX001	19.00	22.30	400PCS
A1009RS215AA4TXXBX001	24.00	27.30	400PCS



# A1009 501330

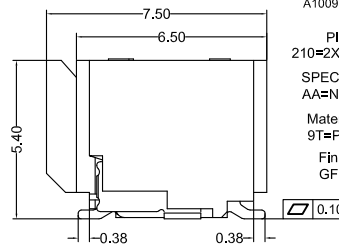
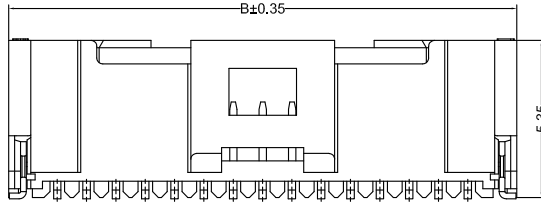
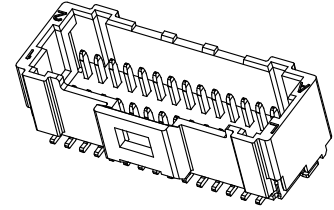
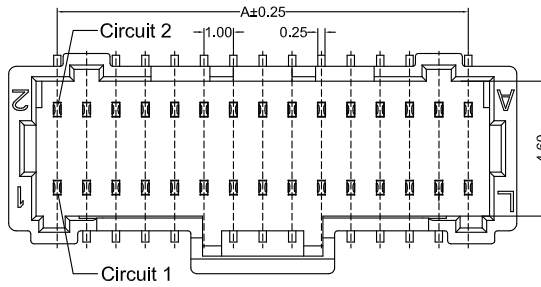

A1009VS 2XX AA 9T GF BA 112

PIN  
210=2X10PINS  
SPECIAL  
AA=NO Special  
Material  
9T=PA9T 94V-0  
Finish  
GF=Terminal Gold-Plated

Code  
112  
Color  
A=Natural  
PackIng  
B=Tape & Reel

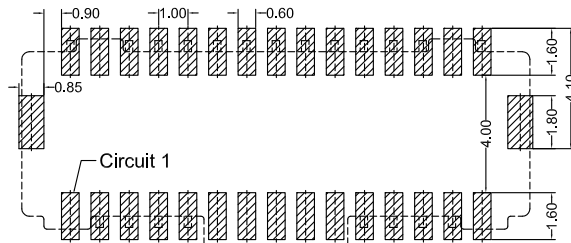

Recommended P.C.B Layout  
General Tolerance±0.05

CSG PART NO.	Dimension mm		Q'ty/BAG
	A	B	
A1009VS210AA9TGFBA112	9.00	12.30	800PCS
A1009VS215AA9TGFBA112	14.00	17.30	800PCS
A1009VS220AA9TGFBA112	19.00	22.30	800PCS
A1009VS225AA9TGFBA112	24.00	27.30	800PCS

